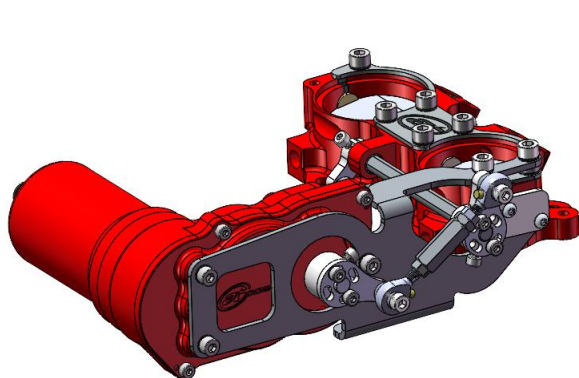

**AT Power Throttles Ltd**

Unit 9, Chestnut Drive  
Wymondham,  
Norfolk  
NR18 9SB

Tel: +44 (0)1953 857800  
Email: [info@atpowerthrottles.com](mailto:info@atpowerthrottles.com)  
Web: [www.atpowerthrottles.com](http://www.atpowerthrottles.com)

**DRIVE BY WIRE ACTUATOR CONFIGURATION****DCOE 2 CYLINDER THROTTLES**

MOUNT 'A' STRAIGHT LEFT  
PART No. 102-106-00055

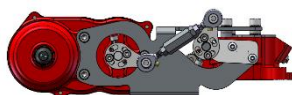

MOUNT 'B' STRAIGHT RIGHT  
PART No. 102-106-00056

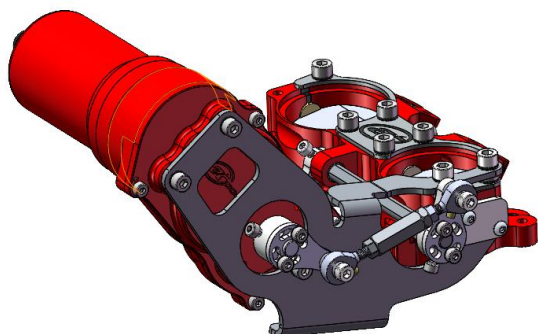

MOUNT 'C' 45 DEGREES LEFT  
PART No. 102-106-00080

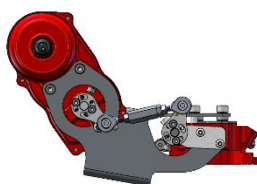

MOUNT 'D' 45 DEGREES RIGHT  
PART No. 102-106-00066

**NOTE:**

**ACTUATOR DESIGNED TO FIT ON RIGHT HAND SIDE ONLY**

BESPOKE OPTIONS ON REQUEST BUT WILL INCUR DESIGN & CNC PROGRAMING COST. PLEASE CONTACT AT POWER FOR ADVICE

We reserve the right to make technical changes or modify the contents of this document without prior notice. With regards to purchase orders, the agreed particulars shall prevail. AT Power does not accept any responsibility whatsoever for potential errors or possible lack of information in this document.